

Drop-in Isolator SMF635F1100



Specifications are subject to change without notice

Specifications (+25°C)

Parameter	Value
RF Frequency	11.2 GHz to 13.7 GHz
Isolation	18 dB (min)
Insertion Loss	0.5 dB (max)
VSWR	1.3:1
Peak Power	10 Watts (max)
Average Power	1 Watts (max)
Power Forward	1 Watts
Power Reverse	0.5 Watts
Operating Temperature	-40 to +85 °C
Package Size	0.25 x 0.50 x 0.18"

Outline Drawing

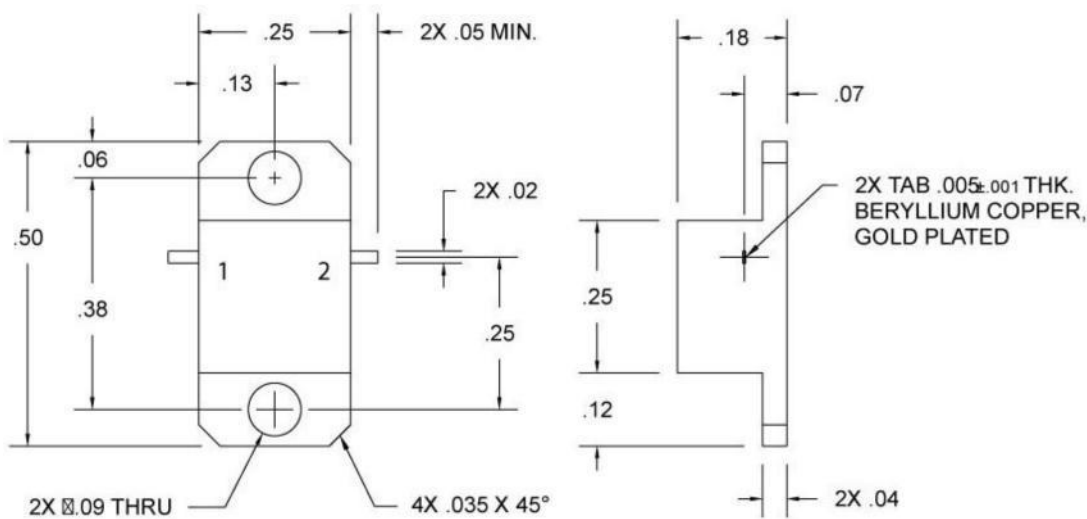

All dimensions are in inches

Need More Help? Need a Variant of This Product?

Contact Mercury's RF & Microwave engineering team at rf.microwave@mrcy.com or visit www.mrcy.com/rf for a detailed listing of RF and Microwave products.

