

Drop-in Isolator SMF635F1702



Specifications are subject to change without notice

Specifications (+25°C)

Parameter	Value
RF Frequency	17.7 GHz to 19.7 GHz
Isolation	20 dB (min)
Insertion Loss	0.5 dB (max)
VSWR	1.25:1
Peak Power	5 Watts (max)
Average Power	0.5 Watts (max)
Power Forward	0.5 Watts
Power Reverse	0.5 Watts
Operating Temperature	-40 to +85°C
Package Size	0.25 x 0.50 x 0.18"

Outline Drawing

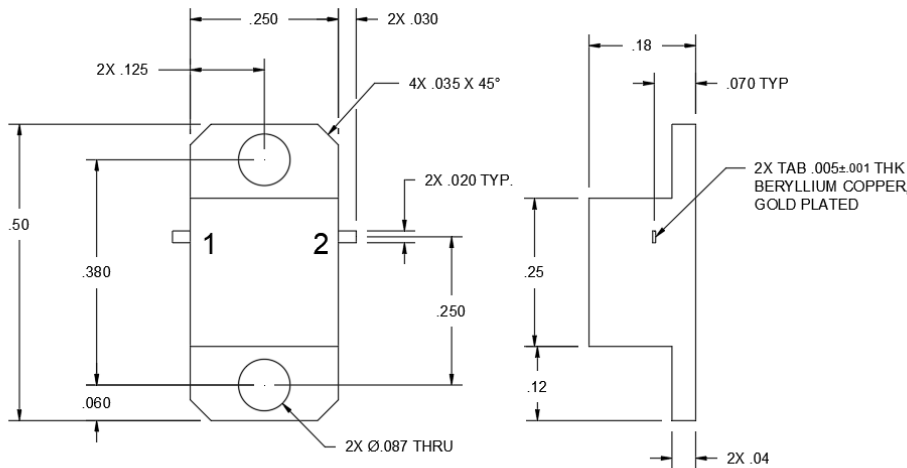

All dimensions are in inches

Need More Help? Need a Variant of This Product?

Contact Mercury's RF & Microwave engineering team at rf.microwave@mrcy.com or visit www.mrcy.com/rf for a detailed listing of RF and Microwave products.

