

Drop-in Isolator SMF635F1010



Specifications are subject to change without notice

Specifications (+25°C)

Parameter	Value
RF Frequency	10.95 GHz to 12.75 GHz
Isolation	18 dB (min)
Insertion Loss	0.6 dB (max)
VSWR	1.3:1
Peak Power	10 Watts (max)
Average Power	1 Watts (max)
Power Forward	5 Watts
Power Reverse	0.5 Watts
Operating Temperature	-20 to +75°C
Package Size	0.25 x 0.50 x 0.18"

Outline Drawing

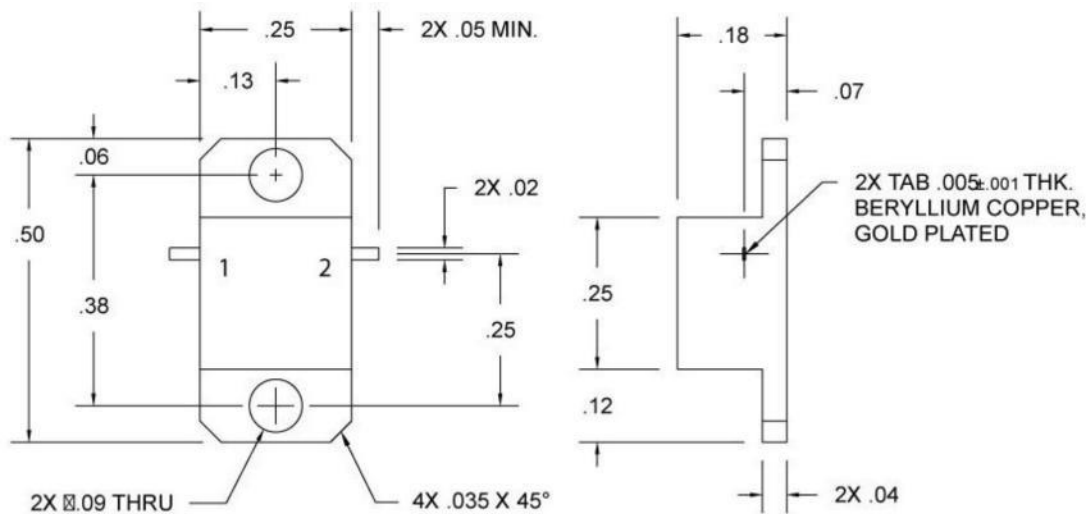

All dimensions are in inches

Need More Help? Need a Variant of This Product?

Contact Mercury's RF & Microwave engineering team at rf.microwave@mrcy.com or visit www.mrcy.com/rf for a detailed listing of RF and Microwave products.



Corporate Headquarters • 50 Minuteman Road • Andover, MA 01810 USA • (978) 967-1401 • (866) 627-6951 • Fax (978) 256-3599 • www.mrcy.com

7183.00E-0119-ss-SMF635-F1010-ferrite