

Drop-in Circulator SMF635-F0700



Specifications are subject to change without notice

Specifications (+25°C)

| Parameter | Value |
|-----------------------|---------------------|
| RF Frequency | 7.8 GHz to 8.3 GHz |
| Isolation | 20 dB (min) |
| Insertion Loss | 0.5 dB (max) |
| VSWR | 1.25:1 |
| Peak Power | 20 Watts (max) |
| Average Power | 2 Watts (max) |
| Power Forward | 5 Watts |
| Power Reverse | 0.5 Watts |
| Operating Temperature | -40 to 85°C |
| Package Size | 0.26 x 0.50 x 0.18" |

Outline Drawing

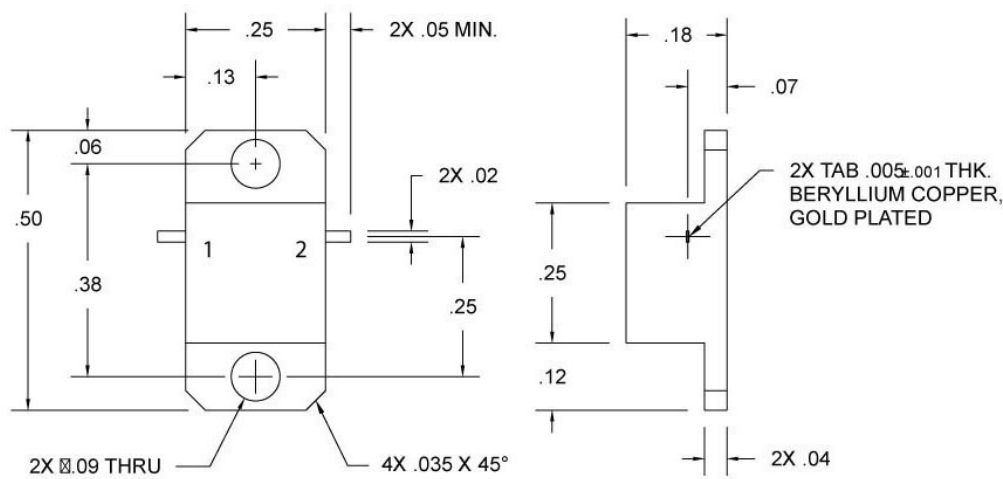

All dimensions are in inches

Need More Help? Need a Variant of This Product?

Contact Mercury's RF & Microwave engineering team at rf.microwave@mrcy.com or visit www.mrcy.com/rf for a detailed listing of RF and Microwave products.



Corporate Headquarters • 50 Minuteman Road • Andover, MA 01810 USA • (978) 967-1401 • (866) 627-6951 • Fax (978) 256-3599 • www.mrcy.com