

# Low-Pass Filter

## C3705



Specifications are subject to change without notice

### Electrical Specifications (+25°C)

Parameter	Value
Passband	1 to 7000 MHz
Insertion Loss	0.5 dB Maximum
VSWR	1.5:1 Maximum
Rejection	25 dB from 10000 to 11000 MHz 40 dB from 11000 to 25000 MHz
Connectors	SMA Female per MIL-C-39012

### Outline Drawing

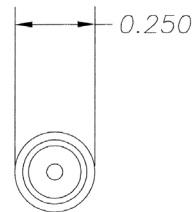
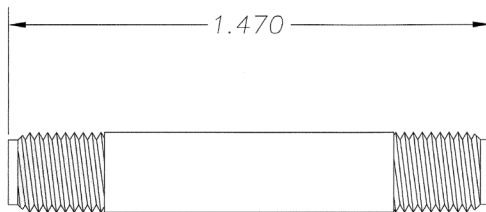

All dimensions are in inches

### Need More Help? Need a Variant of This Product?

Contact Mercury's RF & Microwave engineering team at [rf.microwave@mrcy.com](mailto:rf.microwave@mrcy.com) or visit [www.mrcy.com/rf](http://www.mrcy.com/rf) for a detailed listing of RF and Microwave products.



Corporate Headquarters • 50 Minuteman Road • Andover, MA 01810 USA • (978) 967-1401 • (866) 627-6951 • Fax (978) 256-3599 • [www.mrcy.com](http://www.mrcy.com)

6776.00E-0718-SS-C3705-filter